

High Power Brazed Attenuators

2A100xxx

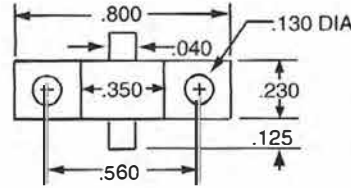
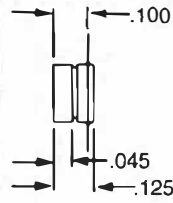
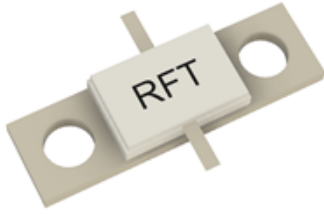

Power	100 Watts
Frequency	VSWR
DC - 1 GHz	1.25:1
1 - 2 GHz	1.35:1

2E100xxx

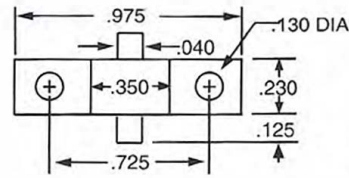
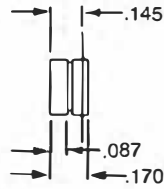
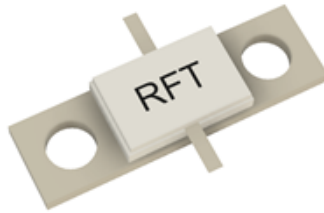

Power	100 Watts
Frequency	VSWR
DC - 1 GHz	1.25:1
1 - 2 GHz	1.35:1

2J250xxx

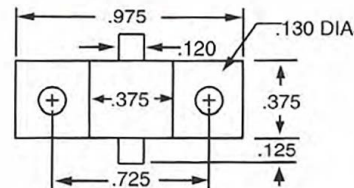
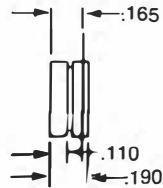

Power	200 Watts
Frequency	VSWR
DC - .5 GHz	1.25:1
.5 - 1 GHz	1.35:1

2Y050xxx

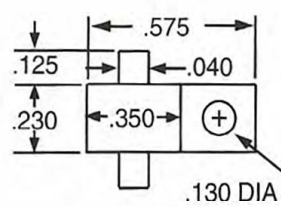
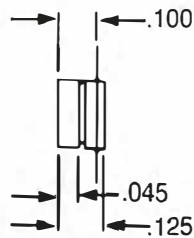

Power	50 Watts
Frequency	VSWR
DC - 1 GHz	1.25:1
1 - 2 GHz	1.35:1

2Z020xxx

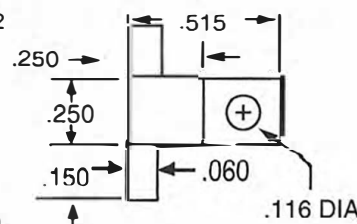
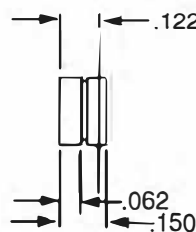
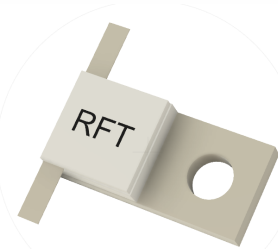

Power	20 Watts
Frequency	VSWR
DC - 1 GHz	1.25:1
1 - 2 GHz	1.35:1

High Power Brazed Attenuators

2L010xxx

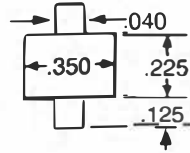
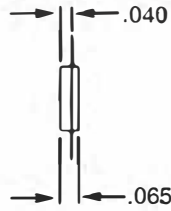

Power	100 Watts
Frequency	VSWR
DC - 1 GHz	1.25:1
1 - 2 GHz	1.35:1

2L100xxx

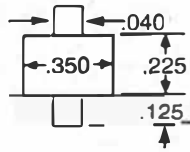
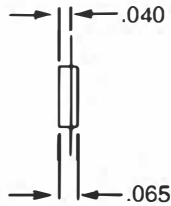

Power	100 Watts
Frequency	VSWR
DC - 1 GHz	1.25:1
1 - 2 GHz	1.35:1

2Q250xxx

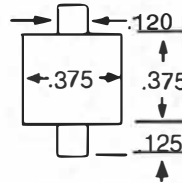
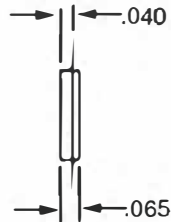

Power	150 Watts
Frequency	VSWR
DC - 1 GHz	1.25:1
1 - 2 GHz	1.35:1

2ZZ40xxx

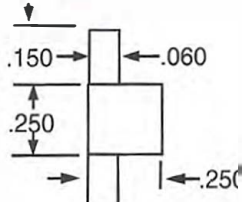
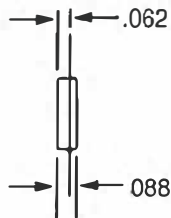

Power	40 Watts
Frequency	VSWR
DC - 1 GHz	1.25:1
1 - 2 GHz	1.35:1

xxx denotes attenuation values. Standard attenuation values:
 1dB,2dB,3dB,4dB,5dB,6dB,8dB,10dB,14dB,20dB,30dB.
 Other values from .5 to 30dB are available in .5dB steps.
 Standard tolerance is +/- .5dB.